

HONDA OUTBOARD MOTOR BF20A · BF25A

SHOP MANUAL NEWS

Power Equipment

News No. P/P-032	Issue Date August '94
---------------------	--------------------------

SOME PARTS OF CHANGES

Applicable information	Publication No.
BF20A · BF25A	66ZV700

CHANGE LOCATIONS

The part numbers of the pin driver, 4mm and the special tool illustrations have been corrected as follows.

- Pin driver , 4mm

BEFORE MODIFICATION

07944-9350200



AFTER MODIFICATION

07744-0010300
or 07944-SA00000

- Special tool illustrations

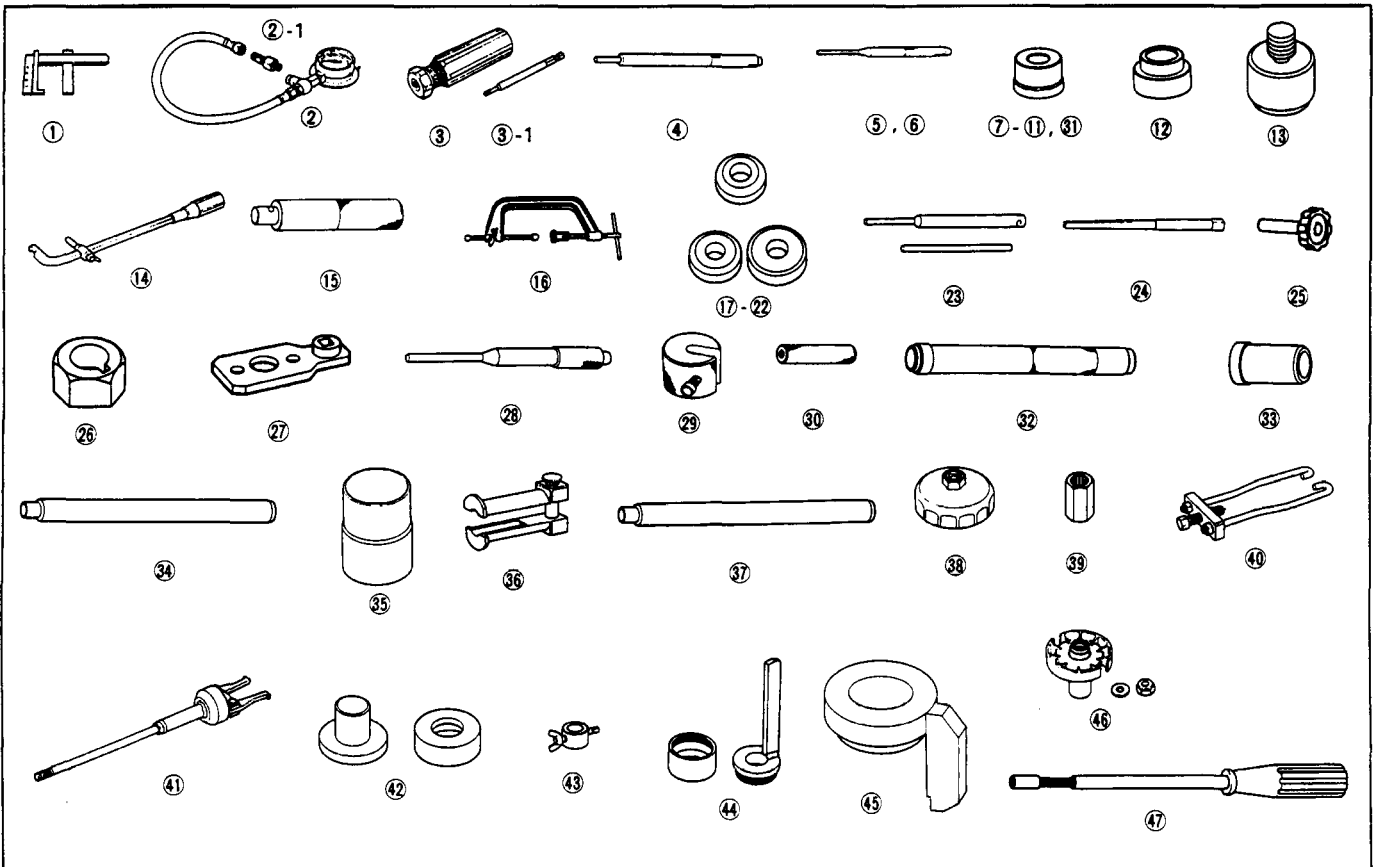

HONDA MOTOR CO., LTD.
SERVICE PUBLICATIONS